

HEALTH CONNECT PARTNERS

HOSPITAL PHARMACY

CONFERENCE | **SPRING 14**



CardinalHealth

Essential to care™

What makes someone a healthcare expert?

Take a brilliant mind and add education and experience.



Lee Murdaugh

Ask me about

Accreditation compliance; sterile compounding; medication safety; competence assessment



Natasha Nicol

Ask me about

Patient safety; just culture; preventing medication errors using technology; Disclosure; pharmacy consultative services



Patricia Kienle

Ask me about

Accreditation compliance; medication administration; medication safety; compounding; leveraging pharmacy as a strategic asset



Mary Baxter

Ask me about

Leveraging the hospital pharmacy as a strategic asset; population health; healthcare strategy; hospital operations

Meet our Experts 
on *Essential Insights*
[cardinalhealth.com/
pharmacyexperts](http://cardinalhealth.com/pharmacyexperts)

WELCOME



Welcome to St. Louis and our 2014 Spring Hospital Pharmacy Conference! We are so glad that you are able to join us. Special thanks to Cardinal Health, our title sponsor. Their continued support is invaluable to the success of this event.

We are excited to share that our Supplier Showcases continue to grow! They are open on Monday only from 12:00 noon – 4:00 pm in Grand D & E. This opportunity will give a few select supplier companies the chance to share their products, services and technology before the *Reverse EXPO*. Stop by to check it out, and if you are interested in having a showcase of your own next year, see us at the HCP table in the expo hall to let us know.

As always, this conference features two *Reverse EXPO* sessions, sponsored by Cantrell Drug Company, to help build relationships between providers and suppliers. During the *Reverse EXPO* sessions, the Pharmacy Directors, along with GPO Executives, will host the booths while the suppliers walk through the expo hall. This unique event is a fun change of pace from traditional expo formats and provides the best networking opportunity for both providers and suppliers.

Over the next few days, our conference will provide you with numerous networking opportunities as well as educational sessions led by some of the top healthcare executives and speakers in the nation. Topics include “ACOs – The State of the Union,” “Transitions of Care and the Role of the Pharmacist,” “Drug Diversion” and “Achieving Provider Status.” We are also proud to present Shep Hyken, *CSP, CPAE* as our keynote speaker for an entertaining session entitled “The Amazement Revolution”.

We hope you find this conference to be informative and useful in helping you make the connection. If you need assistance at any time, please stop by the registration desk and we will be happy to help however we can.

Sincerely,

Jason Green
Partner
Chief Sales Officer

Title Sponsor



HEALTH CONNECT PARTNERS



JASON GREEN
Chief Sales Officer
Hilton Head, SC

Jason Green holds the post of Chief Sales Officer for Health Connect Partners. He has extensive experience in the healthcare industry, working in both large corporate environments and small start-up healthcare organizations. Jason's ability to relate to customers and colleagues has allowed him to foster many long-term relationships throughout the healthcare industry.

Jason and his wife Dana have two children, Max (11) and Ella Kate (4), who keep him dedicated to a busy social calendar. Ella Kate is involved with soccer, gymnastics, dance recitals and anything that is music related. She loves to sing and can often be found with a microphone in her hand, singing and dancing to the newest hip songs. Max is involved in many sporting activities: soccer, hockey, basketball. Max's true passion is golf. When not doing his homework, he can be found with his bag and clubs at the course working on his game. Exciting times ahead as we look to qualify again for the US Kids World Tournament in Pinehurst, NC as well as the Jay Haas Thornblade Golf Tournament later this summer.

During the break in activity, Jason enjoys playing golf, snow skiing, and anything that involves water. He is actively involved in his community serving on many charitable volunteer boards. Jason is a graduate of Ohio University. He has an exciting year planned and looks forward to knocking off a few items on his bucket list: Pebble Beach, anyone?

David Mason is Co-Founder and CEO of Health Connect Partners. Prior to founding HCP, he was Founder and President of BCX Technology, Inc., a software automation company specializing in supply automation for acute care hospitals. He led the BCX team for eight years and sold the company in 2003 to Omnicell.

David and his wife Tammy have two wonderful children, Alexis (20) and Madison (13). Alexis is married to Zac Morgan and they live in Johnson City, TN where Zac attends physical therapy school at East Tennessee State University. Madison stays busy with music lessons and is very good at piano. An avid boater, David spends his time boating with his family, fishing, diving, lobster hunting, spear fishing, running, swimming, and cycling. David enjoys Corvettes and participates in autocross events in his 2007 Corvette with his local Corvette club. David is a graduate of Nashville State Technical Institute, Chairman of the Board for BCX Foundation (a nonprofit educational foundation for children), a Black Belt in Wado Ryu Karate and an Eagle Scout.



DAVID MASON
Chief Executive Officer
Lebanon, TN



NELSON HENDRY
President
Palm Harbor, FL

Nelson Hendry, Co-Founder and President, oversees the Providers registrations and participation at all HCP Conferences. Prior to founding HCP, he served as Regional Vice President of Corporate Sales for Omnicell, working with large IDN Health Systems and the major GPOs. He was awarded the 2005 Salesman of the Year Award for Omnicell's Specialty Sales. Nelson graduated with a Bachelor of Science degree from Florida State University in 1981.

Nelson and his wife Evelyn have three boys. Joseph (26) is a 3D video game artist at Pocket Gems in San Francisco, and enjoys weight lifting in his spare time. Justin (24) is a recent M.I.T. Graduate with a degree in Mechanical Engineering and is now an equity stock trader at KTG Trading Group in Austin, TX. Taylor (11) is about to complete the fifth grade in the gifted program at Brooker Creek Elementary and loves playing flag football, video games, and soccer. He will start 6th grade at Berkley Prep in Tampa in the Fall.

THERE'S AN **EASIER WAY** TO KEEP
TUBE DELIVERIES

OUT OF THE **'BLACK HOLE'**



MedEx TubeTrack

Looking to keep tube deliveries out of the hospital's 'black hole'? MedEx TubeTrack secures and tracks medications sent through pneumatic tube systems to guarantee they reach their intended recipient.

With no changes to your existing pneumatic tube system you can secure and track tube deliveries to their intended recipient. Eliminate delays in care and interruptions of you and your staff, ensure compliance and provide real-time delivery status to nursing and pharmacy.



www.aethon.com/medex

Join us in our hospitality suite: Mills Studio 7

1 ONE UNIT DOSE ONE AND ONLY



HURRICAINE ONE®

Unit Dose Non-Aerosol Spray
20% Benzocaine Oral Anesthetic
0.5 mL each

ORIGINAL WILD CHERRY FLAVOR



An Innovative Non-Aerosol Unit Dose Topical Anesthetic Spray

- Meets Joint Commission Standard for the most ready-to-administer form available.*
- Fast onset. Short duration. Virtually no systemic absorption.
- Utilizes bar code medication administration (BCMA) to accommodate point-of-care scanning.
- Virtually eliminates adverse events resulting from preventable medication errors, ensuring the “5 Rights” are met:
 - ✓ Right Drug ✓ Right Patient ✓ Right Dose ✓ Right Route ✓ Right Time
- Single unit-of-use packaging eliminates the potential for cross-contamination.
- Increases billing accuracy and improves supply chain costs.

ORDERING INFORMATION

NDC#	AMERISOURCE BERGEN	CARDINAL HEALTH	MCKESSON	MORRIS & DICKSON	PRODUCT
0283-0610-11	048-855	CIN 4362547	1410125	086611	HurriCaine ONE® Unit Dose Non-Aerosol Spray Box of 2, 0.017 fl. oz. (0.5 mL) each
0283-0610-26	048-868	CIN 4363370	1411925	086629	HurriCaine ONE Unit Dose Non-Aerosol Spray Box of 25, 0.017 fl. oz. (0.5 mL) each

If HurriCaine ONE is not yet available through your wholesaler, request it by name and NDC Number.

*Joint Commission Standard: MM.05.01.11, EP4



MAKE THE SWITCH TODAY.

Call 1-800-238-8542 to place your order or request more information.
www.beutlich.com. HurriCaine ONE is a registered trademark of Beutlich® Pharmaceuticals, LLC. HCOA 650 0713

AGENDA AT A GLANCE



MONDAY MAY 5

9:00am – 11:00am	Breakfast Presentations	<i>Invitation Only</i>
11:00am – 7:30pm	Supplier Registration	Grand Registration Desk
11:30am – 4:00pm	Provider Registration	Grand A, B & C
12:00pm – 4:00pm	Supplier Showcase	Grand D & E
4:15pm – 5:30pm	Provider Orientation	Regency Ballroom
5:30pm – 6:15pm	Provider Dinner	Regency A & B
6:00pm – 6:30pm	Supplier Orientation	Regency Ballroom
6:30pm – 7:30pm	Welcome Reception	Regency C
7:30pm –	Hospitality Suites	4th & 6th Floors

TUESDAY MAY 6

7:00am – 6:00pm	Registration Desk Open	Regency Registration Desk
7:00am – 8:00am	Breakfast	Regency A & B
8:00am – 9:30am	Opening Remarks & Keynote Address	Regency Ballroom
9:30am – 9:45am	Coffee Break	Regency Prefunction
9:45am – 10:45am	Educational Session	Regency Ballroom
11:00am – 12:00pm	Educational Session	Regency Ballroom
11:30am – 1:00pm	Lunch	Regency A & B
1:15pm – 2:30pm	Educational Session	Regency Ballroom
3:00pm – 5:00pm	Reverse EXPO Session 1	Grand Ballroom
6:00pm – 10:00pm	City Museum	City Museum

Shuttles will run continuously between the Hyatt and the City Museum from 5:50pm – 10:00pm

WEDNESDAY MAY 7

7:00am – 12:00pm	Registration Desk Open	Regency Registration Desk
7:00am – 8:00am	Breakfast	Regency A & B
8:00am – 9:00am	Educational Session	Regency Ballroom
9:30am – 11:30am	Reverse EXPO Session 2	Grand Ballroom



HYATT REGENCY AT THE ARCH



Second Floor

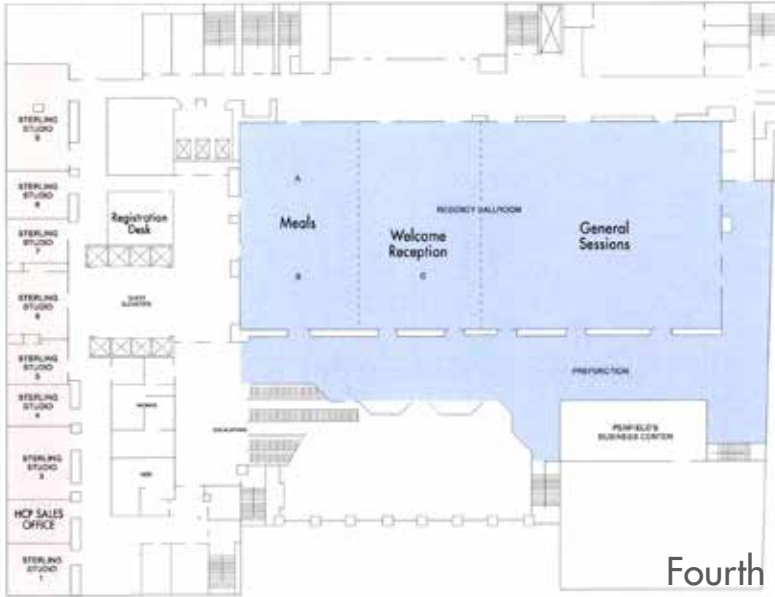

Fourth Floor



Sixth Floor

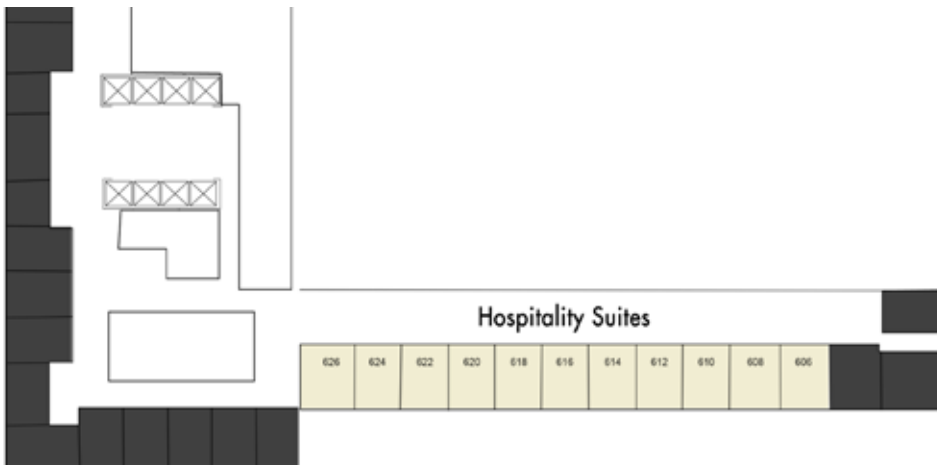



Heritage[®]

Your Proven Formula for Success: High Quality + Consistent Supply

With continuous product expansion and state-of-the-art manufacturing facilities producing over 150 products spanning multiple dosage forms — from oral liquids and solids to complex injectables — Heritage continues to build our portfolio to meet your needs and deliver the Value Driven Medicine required to keep you competitive in the marketplace.

Learn more about our expanding
portfolio of oral solids and injectables.



HERITAGE PHARMACEUTICALS INC.
866-901-1230 ■ WWW.HERITAGEPHARMA.COM



How far can you reach?

Only Omnicell offers a medication and supply automation system that supports health care enterprises seeking to extend beyond the hospital walls. The Omnicell® Unity platform allows you to centrally manage systems in multiple sites, including non-acute care, and provides the flexibility of cloud networking and integrated analytics. To make medication management workflow safer and more efficient, we offer advanced interoperability solutions with other HIT systems.

Omnicell Unity—*helping you extend your reach wherever you deliver care.*

To learn more contact your Omnicell representative, call 855-306-7926, or visit www.Omnicell.com.





GRAND D & E

MONDAY, MAY 5 • 12:00 pm - 4:00 pm

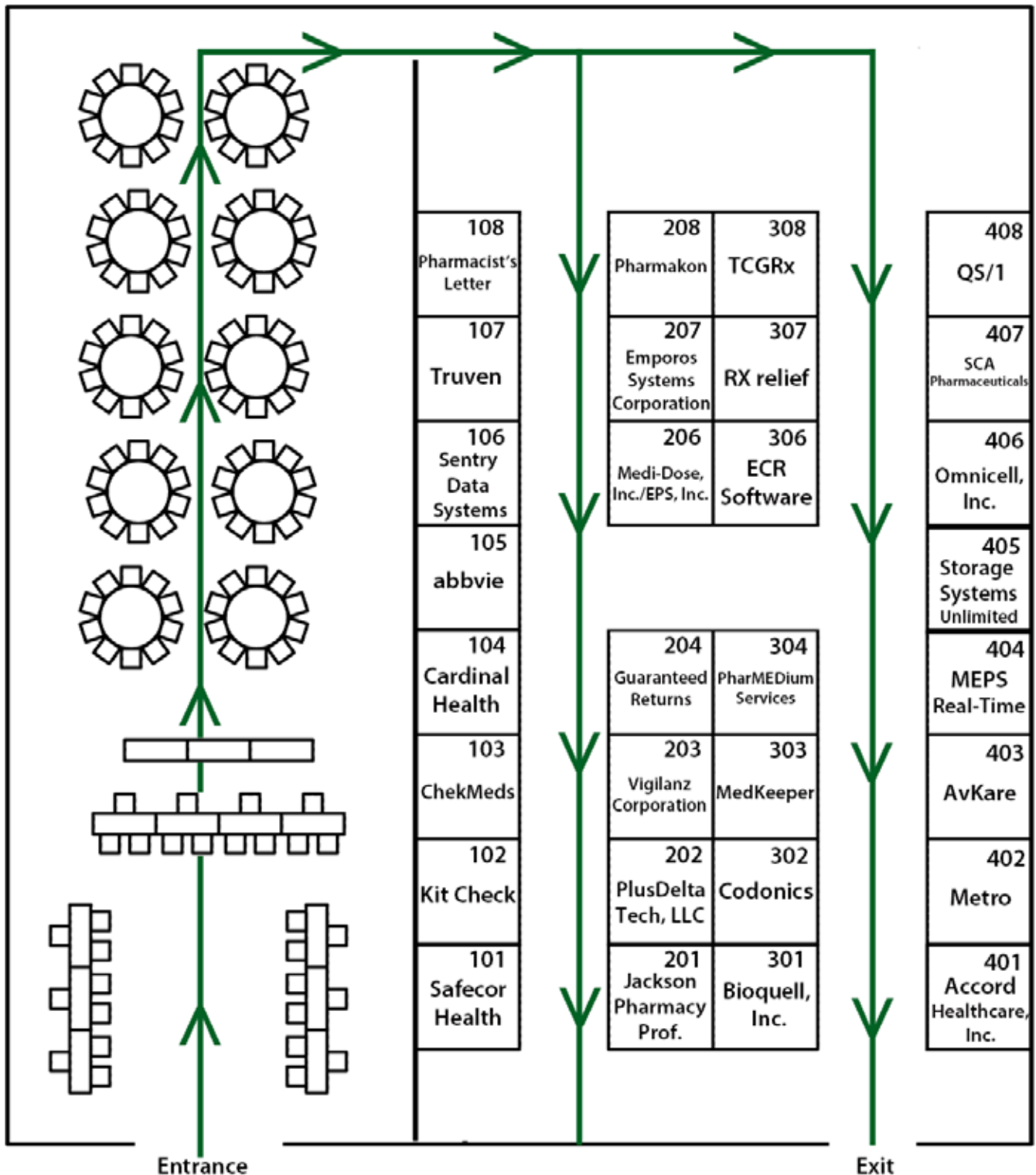

Entrance

Exit

HOSPITALITY SUITES



DON'T MISS OUT ON THE **HOSPITALITY SUITES**

Monday Night following our Welcome Reception



7:30 PM - ...

BE SURE TO VISIT THE TITLE SPONSOR'S SUITE
4TH FLOOR • ROOM MILLS STUDIO 3



PROVIDERS:

Don't forget your badge – you will need it to enter the hospitality suites. Start your evening in the suite that matches the logo on the back of your badge. If you are scanned into 15 hospitality suites, you will be entered in a drawing for an autographed guitar.

HOSPITALITY SUITES



MONDAY, MAY 5 • 7:30 pm - ...

SPONSOR	LEVEL	ROOM
Cardinal Health	4th Floor	Mills Studio 3
Actavis	4th Floor	Mills Studio 4
Aethon	4th Floor	Mills Studio 7
AMAG	6th Floor	Room 610
AmerisourceBergen	6th Floor	Room 614
Cadence Pharmaceuticals	6th Floor	Room 616
Cantrell Drug Company	4th Floor	Mills Studio 1
CRE & Progressive	6th Floor	Room 608
CSL Behring	6th Floor	Room 612
DynaLabs	6th Floor	Room 606
Grifols	4th Floor	Mills Studio 5
Johnson & Johnson	6th Floor	Room 620
McKesson	4th Floor	Mills Studio 8
Pacira	6th Floor	Room 624
PDM Healthcare	6th Floor	Room 622
PharMEDium	6th Floor	Room 626
Prodigy	6th Floor	Room 618
Salix Pharmaceuticals	4th Floor	Mills Studio 2
Truven Health Analytics	4th Floor	Mills Studio 6
Unique Pharmaceuticals (UPI)	4th Floor	Mills Studio 9





JOIN US AT THE **CITY MUSEUM**

Come prepared to eat & **play the night away!**

On Tuesday night, May 6th, join us for an unforgettable evening at the City Museum, where the imagination runs wild!

Housed in the 600,000 square-foot former International Shoe Company, the museum is an eclectic mixture of children's playground, funhouse, surrealistic pavilion, and architectural marvel made out of unique, found objects.

Shuttles will run continuously between the Hyatt and the City Museum from 5:50 pm - 10:00 pm.



SPONSORED BY:





A national industry leader, PDM Healthcare has provided supply chain management, group purchasing, business consulting, revenue cycle management, marketing/advertising, professional education, and conferencing services to the healthcare industry for over 25 years.

We service the full spectrum of healthcare industry, from hospitals to alternate care, pharmacies and physicians, representing \$7 Billion in business transactions. Delivering quality, seamlessly integrated, innovative services has been a daily responsibility for PDM Healthcare since our inception.

PDM provides services leveraging experience in formulary management, public policy, legislative advocacy, community and professional education, and volume purchasing to create unique and successful programs that allow our clients to better analyze a product's attributes, cost-effectiveness, clinical efficacy, and market position through a complete, step-wise evaluation of a product's value in terms of market share, outcomes, and profitability to both the healthcare sector and manufacturers.



HEALTHCARE MANAGEMENT SPECIALISTS

24700 Center Ridge Road Suite 110 * Cleveland, Ohio 44145 * www.pdmhealthcare.com

Phone: 440-871-1721 * Fax: 440-871-1722



TUESDAY MAY 6

OPENING REMARKS AND KEYNOTE ADDRESS

8:00 AM - 9:30 AM • Regency Ballroom
1.5 credit hours



Keynote Speaker: Shep Hyken, CSP, CPAE

Shep Hyken is a customer service expert, professional speaker and bestselling author who works with companies and organizations who want to build loyal relationships with their customers and employees. His articles have been read in hundreds of publications, and he is the bestselling author of *Moments of Magic*, *The Loyal Customer*, *The Cult of the Customer* and *The Amazement Revolution*. He is also the creator of The Customer Focus program which helps clients develop a customer service culture and loyalty mindset. In 1983, Shep founded Shepard Presentations and since then has worked with hundreds of clients ranging from Fortune 100 size organizations to companies with less than 50 employees. Some of his clients include American Airlines, AAA, Anheuser-Busch, AT&T, AETNA, Abbot Laboratories, American Express – and that’s just a few of the



LEARNING OBJECTIVES:

During this powerful session, attendees will learn:

- The difference between satisfied “customers” and loyal “customers”
- The importance of managing “interactions” with your “customers” (*Moments of Truth*, *Moments of Misery™* and *Moments of Magic®*)
- Specific tactics and tools that will help you and your team deliver an amazing service experience

A’s! He has been inducted into the National Speakers Association Hall of Fame for lifetime achievement in the speaking profession. He is known for his high-energy presentations, which combine important information with entertainment to create exciting programs for his audiences.



TUESDAY MAY 6

EDUCATIONAL SESSION: ACOS – THE STATE OF THE UNION

9:45 AM - 10:45 AM • Regency Ballroom

1 credit hour

TRUVEN[®]
HEALTH ANALYTICS™

Speaker: Ken Perez

Vice President

Omniceil, Inc

Ken serves as Vice President of Healthcare Policy for Omnicell, Inc., a leading supplier of comprehensive automation and business analytics software for patient-centric medication and supply management. In this thought leadership role, he supports the company's strategy, business development and marketing functions. Ken is a frequent speaker at healthcare industry events. He writes a column on health reform-related issues for hfm, and he contributes articles and commentary to numerous other publications, including Accountable Care News, Becker's Hospital Review, Healthcare Finance News, HealthLeaders, Modern Healthcare and U.S. News & World Report.



Ken previously served as Senior Vice President of Marketing and Director of Healthcare Policy for MedAnalytics, a provider of performance management solutions for the healthcare market. He has over 20 years of experience in business, serving in senior marketing, business development and finance roles for healthcare IT and technology companies. Ken earned his bachelor's degree in international relations from Stanford University and a master's in business administration with a concentration in finance from UCLA.

LEARNING OBJECTIVES:

During this session, attendees will learn:

- The societal and legislative drivers
- Comparison of Medicare and commercial ACO metrics
- The new math for hospital finances in ACOs
- Best practices
- The end game





TUESDAY MAY 6

EDUCATIONAL SESSION: TRANSITIONS OF CARE AND THE ROLE OF THE PHARMACIST

11:00 AM - 12:00 PM • Regency Ballroom
1 credit hour



Speaker: Michael Paasche-Orlow, MD, MA, MPH

Associate Professor of Medicine
Boston University School of Medicine

Michael Paasche-Orlow is Associate Professor of Medicine, Boston University School of Medicine. Dr. Paasche-Orlow is a general internist and a nationally recognized expert in the field of health literacy. Dr. Paasche-Orlow is currently a co-investigator with five funded grants that examine health literacy, including two intervention studies evaluating simplified information technologies for behavior change among minority patients with a range of health literacy levels. Dr. Paasche-Orlow is a member of the Project RED research team, a nationally recognized model to re-engineer the process of hospital discharge to improve the safety and efficiency of transitions of care. Dr. Paasche-Orlow's work has brought attention to the role health literacy plays in racial and ethnic disparities, self-care for patients with chronic diseases, end-of life decision making, and the ethics of research with human subjects. Dr. Paasche-Orlow is the Associate Program Director for the Boston University School of Medicine General Internal Medicine Academic Post-Doctoral Fellowship Program and the Associate Section Chief for Research for the Section of General Internal Medicine in the Boston University School of Medicine's Department of Medicine.



LEARNING OBJECTIVES:

- Understand federal policies regarding care transitions.
- Understand the evidence behind the ReEngineered Discharge (Project RED) and other evidence based care transition models
- Examine the roles of pharmacists in improving care transitions



TUESDAY MAY 6

EDUCATIONAL SESSION: DRUG DIVERSION

1:15 PM - 2:30 PM • Regency Ballroom
1.25 credit hours



Speaker: Stephen A. Carlson, RPh, MHA

Director of Pharmacy Services

Northeast Georgia Medical Center (NGMC)

Steve Carlson is the Director of Pharmacy Services at Northeast Georgia Medical Center (NGMC) in Gainesville, Georgia. He received his Pharmacy Degree from Philadelphia College of Pharmacy and Science (USP) and a Masters in Healthcare Administration from St. Joseph's University in Philadelphia. He has been at NGMC for 8 years. He is President for Georgia Society of Health System Pharmacists and chairman of Pharmacotherapeutics Committee of Georgia Hospital Association. Steve has given numerous presentations to both state and national groups.



During his tenure at NGMC, Steve has been responsible for the upgrade of the pharmacy information system, the bar-coding at the bedside upgrade and the installation of smart pumps throughout the enterprise. Financially, he has reduced costs by over \$3,000,000

per year by instituting 340b, as well as creating an employee pharmacy, and thorough formulary management. Prior to NGMC, Steve served in various roles at St. Luke's Hospital and Health Network in Bethlehem, PA. His last position was Associate Vice President and Director of Pharmacy.

LEARNING OBJECTIVES:

- Understand the prevalence of drug abuse in healthcare
- Learn how to develop a drug diversion program
- Detect drug diversion
- Learn helpful interviewing methodology
- Understand important reporting requirements

PLEASE NOTE:

BE SURE TO HAVE YOUR NAME BADGE WITH YOU AND SCANNED BEFORE EACH EDUCATIONAL SESSION.
CE CREDIT WILL BE AWARDED BASED ON BADGE SCANS PER DAY.



WEDNESDAY MAY 7

EDUCATIONAL SESSION: ACHIEVING PROVIDER STATUS

8:00 AM - 9:00 AM • Regency Ballroom
1 credit hour

GRIFOLS

Speaker: Joseph Hill

Director of Federal Legislative Affairs

American Society of Health-System Pharmacists (ASHP)

Joseph Hill currently serves as director of federal legislative affairs for the American Society of Health-System Pharmacists (ASHP). He advocates ASHP's positions on critical issues before members of Congress and their staff. Prior to that, he was government affairs manager for the American Society of Consultant Pharmacists, where he represented ASCP before state and federal legislators.

Mr. Hill holds a Master of Arts degree in political science from the University of Tennessee and a Bachelor of Arts in political science from Indiana University of Pennsylvania.



LEARNING OBJECTIVES:

- Gain an historical perspective of provider status efforts and how it has evolved over the years
- Explain the barriers to provider status
- Discuss plans to address them



Educational Review Systems is accredited by the Accreditation Council for Pharmacy Education (ACPE) as a provider of continuing pharmaceutical education. This program is approved for up to 5.75 hours (0.575 CEUs) of continuing pharmacy education credit. Proof of participation will be posted to your NABP CPE profile within 4 to 6 weeks to participants who have successfully completed the post-test. Participants must participate in the entire presentation and complete the course evaluation to receive continuing pharmacy education credit.

ACPE # 0761-9999-14-155-L04-P to 0761-9999-14-159-L04-P



Over the past year, this committee volunteered their valuable time to help us create an outstanding agenda. We appreciate their energy and want to recognize this esteemed group for all their hard work. Without their expertise, this event would not have been possible.



HOSPITAL PHARMACY BOARD CHAIR:

BRIAN ROMIG, BS, RPH, MBA
Corporate Pharmacy Director
Adventist Health System
Altamonte Springs, FL

Mary-Helen Bowen
Assistant VP, Pharmacy Services
St. Dominic Hospital • Jackson, MS

John Kleiss, PharmD
Executive Director
ROi • St. Louis, MO

Arash Dabestani, PharmD, MHA, FASHP, FABC
Senior Director of Pharmacy
NYU Langone Medical Center • New York, NY

Marcelle Levy-Santoro, MS, RPh, FNAPH
Administrator of Pharmacy Services
Nassau University Medical Center • East Meadow, NY

James DeFazio
Director Clinical Value Analysis & Pharmacy
Bon Secours Health System, Inc. • Columbia, MD

Richard Mendribil, Pharm.D.
Health System Director of Pharmacy
Northern Arizona Health • Flagstaff, AZ

James Eldridge, PharmD, MBA
Director, Pharmacy Utilization and Operations
HealthTrust-HCA • Brentwood, TN

Marshall Robbins, PharmD
Director of Pharmacy
Crestwood Medical Center • Huntsville, AL

Amir Emamifar, PharmD, MBA
Associate Administrator, Pharmaceutical Svcs
Emory Healthcare • Atlanta, GA

Michael Sievers, RPh
Network Director, Pharmacy Services
Lutheran Hospital of Indiana • Fort Wayne, IN





THE UNIQUE REVERSE EXPO



In the Reverse EXPO sessions, Hospital Pharmacy Directors, along with GPO Executives, host exhibit tables while suppliers walk through the hall. This unique event is a fun change of pace from traditional expo formats and provides the best networking opportunity for both providers and suppliers.

On the next page, you will find a map outlining the location of each booth in the hall. Please refer to the list of specific booth assignments (pages 24 - 42) to locate each provider executive during the Reverse EXPO.

GRAND BALLROOM

Session 1: Tuesday, May 6, 3:00 PM - 5:00 PM

Session 2: Wednesday, May 7, 9:30 AM - 11:30 AM

SPONSORED BY:



CANTRELL DRUG COMPANY

Pharmaceutical Outsourcing Specialists



EXHIBIT HALL

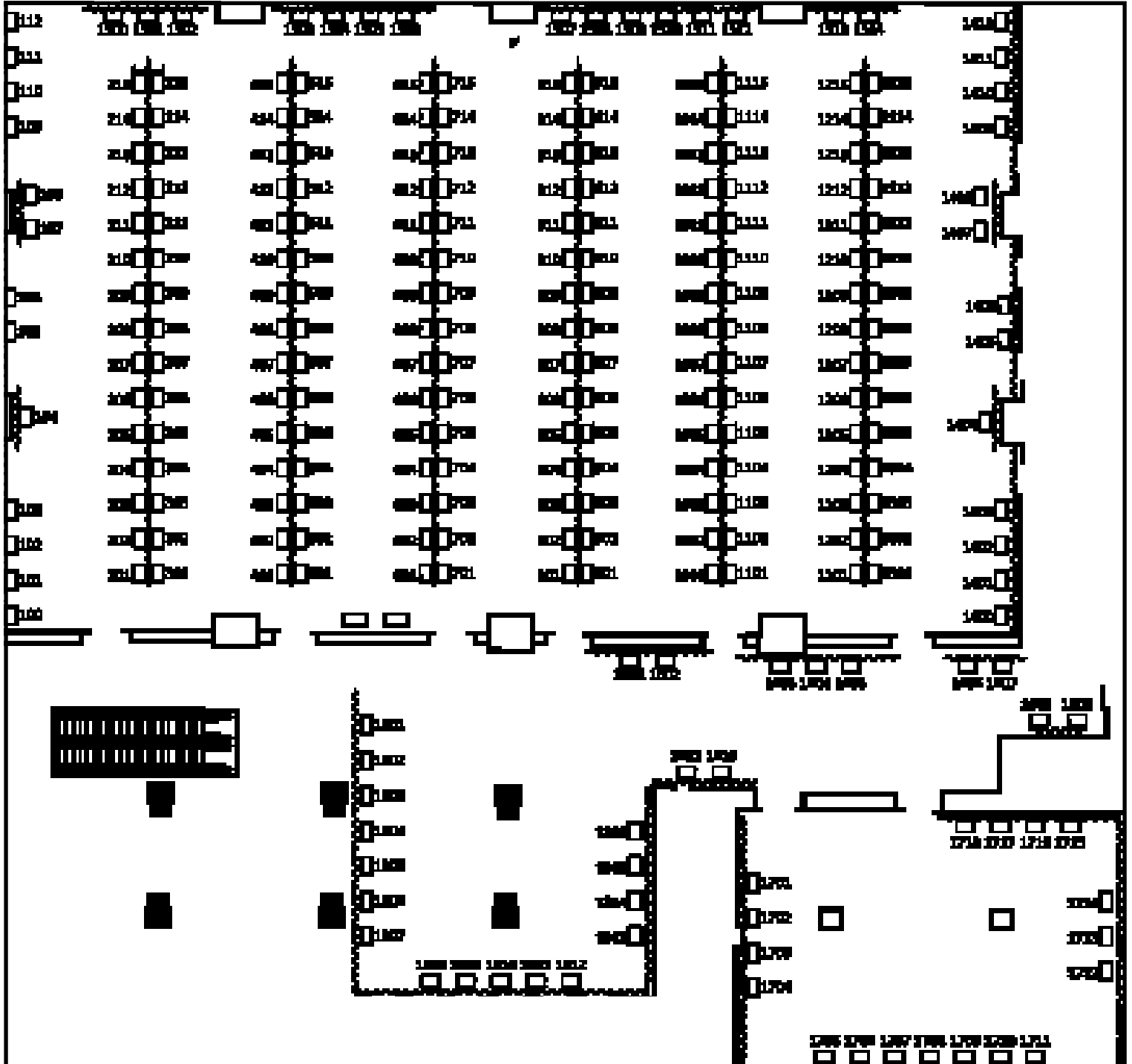

YOUR TRUSTED SOURCE

Please Visit
Our Hospitality Suite On
Monday Evening and
Enjoy Our Famous
"Phrozen Pharmaceuticals"
Mills Studio 1, Fourth Floor



Lance Lanier, BS Pharmacy
Business Development

Tracye Easterly
Regulatory Coordinator

Mike Pierce
President

Dell McCarley, Pharm D
Chairman/CEO

Raymond C. Anderson, PhD
VP Quality Assurance &
Regulatory Affairs

Chris Hutts, Pharm D
Pharmacist in Charge



CANTRELL DRUG COMPANY

Pharmaceutical Outsourcing Specialists

FDA Registered 503B Human Drug Compounding Outsourcing Facility

Our experience with cGMP-focused policies and procedures along with carefully designed facilities, equipment, training and testing, provide confidence to our customers in the quality of our services.

QUALITY › SERVICE › EXPERIENCE

877-666-5222
www.cantrelldrug.com

PROVIDER ATTENDEES LIST BY FACILITY



Abilene Regional Medical Center

Booth # 1716
Abilene, TX
Dustin Harms
Asst Director of Pharmacy
Bedsize: 231

Adventist Health System

Booth # 801
Altamonte Springs, FL
Brian Romig, *BS, RPh, MBA*
Corporate Pharmacy Director
Bedsize: 8382
Outpatient Pharmacy: Yes

Adventist LaGrange Memorial Hospital

Booth # 806
LaGrange, IL
David Tsang
Director of Pharmacy
Bedsize: 200

Aiken Regional Medical Center

Booth # 1213
Aiken, SC
Richard Philipp, *RPh*
Director of Pharmacy
Bedsize: 245

Akron Children's Hospital

Booth # 314
Akron, OH
John Lepto, *R.Ph.*
Director of Pharmacy
Bedsize: 365
Outpatient Pharmacy: Yes

Alameda Hospital

Booth # 1303
Alameda, CA
Ari Arshi, *PharmD*
DOP
Bedsize: 153

All Children's Hospital

Booth # 909
St. Petersburg, FL
Dante Kazerounian, *PharmD, CPh, NPh*
Clinical Systems Pharmacist
Bedsize: 216

Amerinet

Booth # 110
St. Louis, MO
Larry Koesterer
Director
Bedsize: 19748

Amerinet

Booth # 111
Warrendale, PA
Ronald Rovnak
Director, Pharmacy Specialist

Anaheim Regional Medical Center

Booth # 1309
Anaheim, CA
Martin Torres, *PharmD*
Director of Pharmacy
Bedsize: 223

Armstrong Co Memorial Hospital (ACMH)

Booth # 711
Kittanning, PA
Amy McKelvey
Director of Pharmacy
Bedsize: 175

Arnold Palmer Med Center (Orlando Health)

Booth # 702
Orlando, FL
Meena Morgan, *PharmD, CPh*
Administrator Ancillary Services
Bedsize: 1800
Outpatient Pharmacy: Yes

Arrowhead Regional Medical Center

Booth # 1307
Colton, CA
Marvin Finnefrock, *Pharm D*
VP of Clinical Pharmacy
Bedsize: 184

Aultman Hospital

Booth # 1500
Canton, OH
James Toohey, *MS, RPh*
Executive Director of Pharmacy
Bedsize: 682
Outpatient Pharmacy: Yes

Avera McKennan Hospital & Univ Health Ctr

Booth # 104
Sioux Falls, SD
Steve Petersen, *PharmD*
Assistant Vice President - Pharmacy
Bedsize: 545
Outpatient Pharmacy: Yes

Banner Compounding Pharmacy

Booth # 1608
Chandler, AZ
Misty Vo
Pharmacy Director
Bedsize: 4465

Baptist Health

Booth # 1012
Montgomery, AL
Clinton Peevy, *Pharm.D.*
System Director of Pharmacy Services
Bedsize: 650
Outpatient Pharmacy: Yes

Baptist Medical Center South

Booth # 1011
Montgomery, AL
Gary Mount
Director of Pharmacy
Bedsize: 500

Baxter Regional Medical Center

Booth # 1110
Mountain Home, AR
Angela Powell, *PharmD*
Director of Pharmacy
Bedsize: 268
Outpatient Pharmacy: Yes

Bayshore Medical Center

Booth # 1714
Pasadena, TX
Carol Barnes
Pharmacy Director
Bedsize: 500
Outpatient Pharmacy: Yes

Benefis Health System

Booth # 1410
Great Falls, MT
David Runkel
Pharmacy Director
Bedsize: 500

Berkshire Health Systems

Booth # 504
Pittsfield, MA
Keith Preston, *RPh, MS*
Director of Pharmacy Services
Bedsize: 300
Outpatient Pharmacy: Yes

Beth Israel Deaconess Hospital-Plymouth

Booth # 501
Plymouth, MA
Kristina McGill
Director of Pharmacy
Bedsize: 161

Beverly Hospital

Booth # 1310
Montebello, CA
Wayne Campbell
Director of Pharmacy
Bedsize: 223

Billings Clinic

Booth # 1409
Billings, MT
Kyle Townsend, *PharmD, BCPS*
Director of Pharmacy
Bedsize: 272



PROVIDER ATTENDEES LIST BY FACILITY



BJC Healthcare
Booth # 210
St. Louis, MO
SueEllen Turner
Corporate Pharmacy Contract Manager
Bedsizes: 3600
Outpatient Pharmacy: Yes

Blessing Hospital
Booth # 215
Quincy, IL
Bob Miller, *BS PHARM*
Director of Pharmacy
Bedsizes: 312

Blount Memorial Hospital
Booth # 1115
Maryville, TN
Jeanne Ezell, *DPH, MS, FASHP*
Director of Pharmacy
Bedsizes: 304

Boca Raton Regional Hospital
Booth # 902
Boca Raton, FL
Gwenesia Collins, *PharmD*
Director of Pharmacy
Bedsizes: 400

Bon Secours Health System, Inc.
Booth # 410
Columbia, MD
James DeFazio
Director Clinical Value Analysis & Pharmacy
Bedsizes: 3836
Outpatient Pharmacy: Yes

Bothwell Regional Health Center
Booth # 205
Sedalia, MO
W. Bradley Nicholson
Director of Pharmacy
Bedsizes: 150

Bristol Hospital
Booth # 1506
Bristol, CT
Steve Burke
Director of Pharmacy
Bedsizes: 134

Bristol Regional Medical Center
Booth # 1201
Bristol, TN
Dwight Owens, *PharmD*
Director of Pharmacy
Bedsizes: 384

Cape Cod Healthcare
Booth # 503
Hyannis, MA
Peter Scarafale, *RPH, MS*
Director of Pharmacy
Bedsizes: 359
Outpatient Pharmacy: Yes

Capital Health Regional Medical Center
Booth # 510
Trenton, NJ
Chester Lau
Director of Pharmacy
Bedsizes: 289

Capital Region Medical Center
Booth # 212
Jefferson City, MO
John Hamilton, *Pharm. D.*
Director of Pharmacy
Bedsizes: 114

Carilion Clinic
Booth # 1511
Radford, VA
William Lee, *D.Ph, MPA, FASCP*
System Pharmacy Director
Bedsizes: 1200

Carilion Clinic
Booth # 1510
Roanoke, VA
Clara Anne Spencer, *R.Ph.*
Director of Pharmacy Contracting
Bedsizes: 1185
Outpatient Pharmacy: Yes

CaroMont Health
Booth # 1204
Gastonia, NC
Michael Molby, *PharmD*
Director of Pharmacy
Bedsizes: 442
Outpatient Pharmacy: Yes

Catholic Health East-Trinity Inc.
Booth # 613
Newtown Square, PA
Sean Yanchunas, *BS PharmD MBA*
System Director of Clinical Pharmacy
Bedsizes: 12476
Outpatient Pharmacy: Yes

Catholic Health Initiatives
Booth # 1411
Englewood, CO
Venita Papillion, *PharmD*
Director, Clinical Pharmacy Services
Bedsizes: 8000

Centerpoint Medical Center
Booth # 207
Independence, MO
Terry Glazier, *R.Ph.*
Director of Pharmacy
Bedsizes: 221

CentraCare Health
Booth # 105
St. Cloud, MN
Mary Phipps, *PharmD*
System Director of Pharmacy
Bedsizes: 489
Outpatient Pharmacy: Yes

Central Carolina Hospital
Booth # 1207
Sanford, NC
Jan Stewart, *RPh*
DOP
Bedsizes: 137

Centura Health
Booth # 1412
Denver, CO
Quan Pho
VP of Pharmacy
Bedsizes: 4027
Outpatient Pharmacy: Yes

CHE Trinity Health
Booth # 611
Livonia, MI
Christopher Manthey
Director of Pharmacy Informatics
Bedsizes: 10916

Childrens Hospital Los Angeles
Booth # 1401
Los Angeles, CA
Karen Berry
Pharmaceutical Buyer
Bedsizes: 330

Children's Hospital of San Antonio
Booth # 1806
San Antonio, TX
Cynthia Koger, *RPh*
Director of Pharmacy
Bedsizes: 150
Outpatient Pharmacy: Yes

Chippenham Hospital (HCA)
Booth # 1509
Richmond, VA
Jerry Martin, *RPh, MBA*
Director of Pharmacy
Bedsizes: 450
Outpatient Pharmacy: Yes

When You Have to be Right

Two Wolters Kluwer Health companies,
Lexicomp and **Pharmacy OneSource**,
together offer the very best in
drug information, clinical decision
support, pharmacy productivity
and clinical surveillance.

Lexicomp®
800.837.5394
www.lexi.com



Wolters Kluwer
Health

Pharmacy OneSource®
800.654.8395
www.pharmacyonesource.com

Expect more from your drug information.

There's too much on the line to trust out-of-date drug information resources. Elsevier's Gold Standard takes a different approach to deliver the cohesive, comprehensive information that you, your care teams, and your patients need.

Better information.

Elsevier's Gold Standard delivers comprehensive reference, patient education, and pricing information at the point of need ensuring that you have the right information at the right time.

Better technology.

Elsevier's Gold Standard offers an advanced suite of online reference resources designed to fit your workflow – including integration with your EHR.

Better decisions.

We give every member of your staff the specific information that they need to make smarter, faster decisions – leading to better outcomes.

Go ahead. Challenge the status quo – get the comprehensive, timely drug information you need to protect patients, improve consistency, and control costs.

Visit goldstandard.com to see how it all works.

Toll Free 800.375.0943 | goldstandard@elsevier.com | An Elsevier Company

ELSEVIER
GOLD STANDARD

PROVIDER ATTENDEES LIST BY FACILITY



Christus Health

Booth # 1803
Irving, TX
Myra Thomas, *RPh*
Director, Resource Utilization Pharmacy
Bedsizes: 2300

CHRISTUS Health Spohn Memorial Hospital

Booth # 1805
Corpus Christi, TX
Christopher Miller, *PharmD, BCPP*
Director of Pharmacy Services
Bedsizes: 1049
Outpatient Pharmacy: Yes

CHRISTUS Spohn Hospital Corpus Christi-South

Booth # 1802
Corpus Christi, TX
Elias Cavazos, *RPh*
Director of Pharmacy
Bedsizes: 154

CHRISTUS St. Michael Health System

Booth # 1804
Texarkana, TX
Dale Smith, *RPh*
Director of Pharmacy
Bedsizes: 320
Outpatient Pharmacy: Yes

CHRISTUS St. Vincent Regional Medical Center

Booth # 1801
Santa Fe, NM
Christine Atwell
Pharmacy Director
Bedsizes: 240

Citrus Memorial Health System

Booth # 809
Inverness, FL
Craig McCurdy, *MS, RPh*
Director of Pharmacy
Bedsizes: 197

Claxton-Hepburn Medical Center

Booth # 606
Ogdensburg, NY
Greg Guimond, *RPh*
Director of Pharmacy
Bedsizes: 130

Coastal Carolinas Health Alliance

Booth # 1209
Wilmington, NC
Derrick Billups, *MSM, FACHE*
Director of Operations & Corporate Contracts
Bedsizes: 5000
Outpatient Pharmacy: Yes

Columbus Regional Health

Booth # 1002
Columbus, GA
Debbie Nowlin, *RPh*
Associate Director of Pharmacy
Bedsizes: 413
Outpatient Pharmacy: Yes

Columbus Regional Healthcare System

Booth # 1001
Columbus, GA
Burnis Breland, *MS, PharmD, FASHP*
Director of Pharmacy
Bedsizes: 413
Outpatient Pharmacy: Yes

Columbus Regional Hospital

Booth # 201
Columbus, IN
Ben Caughey
Director of Pharmacy
Bedsizes: 325
Outpatient Pharmacy: Yes

Community Health Systems

Booth # 908
Merritt Island, FL
Jeffrey Greer, *PharmD, CRPh, BCNSP*
Divisional Pharmacy Manager
Bedsizes: 4000
Outpatient Pharmacy: Yes

Concord Hospital

Booth # 509
Concord, NH
David DePiero, *MS, RPh*
Director of Pharmacy
Bedsizes: 295

Conroe Regional Medical Center

Booth # 1715
Conroe, TX
Kathleen Belford
DOP
Bedsizes: 322

Conway Medical Center

Booth # 1212
Conway, SC
Robert Gajewski, *BS Pharmacy*
Director of Pharmacy
Bedsizes: 210
Outpatient Pharmacy: Yes

Coosa Valley Medical Center

Booth # 1009
Sylacauga, AL
Donald Haley, *RPh., BSpPharm*
Pharmacy Director
Bedsizes: 223

Coral Gables Hospital

Booth # 813
Coral Gables, FL
Elizabeth Rodriguez Campos, *PharmD*
Director of Pharmacy
Bedsizes: 256

Cottage Health System

Booth # 1404
Santa Barbara, CA
Allan Cohen, *PharmD., MBA*
Director of Pharmacy Services
Bedsizes: 525

Covenant Medical Center

Booth # 106
Waterloo, IA
John Hamiel, *PharmD*
Director of Pharmacy
Bedsizes: 423
Outpatient Pharmacy: Yes

Covenant Medical Inc. Harrison

Booth # 407
Saginaw, MI
Terry Wernette, *Rph*
Director of Pharmacy
Bedsizes: 623
Outpatient Pharmacy: Yes

Crestwood Medical Center

Booth # 1005
Huntsville, AL
Marshall Robbins, *PharmD*
Director of Pharmacy
Bedsizes: 150

Del Amo Hospital

Booth # 1305
Torrance, CA
Bola Akinnisbosun
Pharmacy Director
Bedsizes: 166

Delta Regional Medical Center

Booth # 1015
Greenville, MS
Lisa Fratesi, *RPh*
Director of Pharmacy
Bedsizes: 325

Denton Regional Medical Center

Booth # 1611
Denton, TX
John Kanell, *PharmD, BCPS*
Assistant Director, Pharmacy
Bedsizes: 220



PROVIDER ATTENDEES LIST BY FACILITY



Dr. P. Phillips Hospital (Orlando Hlth)

Booth # 701
Orlando, FL
Michelle Thomas, *RPh, CPh*
Pharmacy Manager
Bedsiz e: 237
Outpatient Pharmacy: Yes

Einstein Healthcare Network

Booth # 708
Philadelphia, PA
Deborah Hauser, *RPh, MHA*
Network Director of Pharmacy
Bedsiz e: 1184
Outpatient Pharmacy: Yes

Elliot Health System

Booth # 508
Manchester, NH
Rob Glew
Director of Pharmacy Services
Bedsiz e: 250

Englewood Hospital and Medical Center

Booth # 512
Englewood, NJ
Jeffrey Nemeth, *BSP h, PharmD, MPA*
Director of Pharmacy
Bedsiz e: 520

Federation of American Hospitals

Booth # 1113
Washington, DC
Kerry Price
VP of Administration Services

Federation of American Hospitals

Booth # 1112
Little Rock, AR
Marci Freeman
Vice President, Administrative Services

FL Hospital Memorial Med Ctr (Adventist)

Booth # 803
Daytona Beach, FL
Marshall Hughey
Director of Pharmacy
Bedsiz e: 270

Flagler Hospital

Booth # 905
St. Augustine, FL
R. David Hoffman, *PharmD*
Pharmacy Operations Coordinator
Bedsiz e: 316

Florida Hospital - Heartland Division

Booth # 802
Sebring, FL
Mala Cullipher
Director of Pharmacy
Bedsiz e: 275

Florida Hospital North Pinellas

Booth # 804
Tarpon Springs, FL
James Lumbard, *MSc*
Director of Pharmacy
Bedsiz e: 168

Florida Hospital Tampa (AHS)

Booth # 805
Tampa, FL
Eric Renker, *PharmD*
Pharmacy Director
Bedsiz e: 475
Outpatient Pharmacy: Yes

Flowers Hospital

Booth # 1006
Dothan, AL
Joe Dalton, *RPh*
Pharmacy Director
Bedsiz e: 235

Franciscan Missionaries of Our Lady Hlth Sys

Booth # 1104
Baton Rouge, LA
Michelle Bush, *RN, CNOR*
Resource Utilization Manager
Bedsiz e: 750

Frederick Regional Healthcare System

Booth # 411
Frederick, MD
Joseph Morrissey, *MS, RPh*
Director, Pharmacy & Supply Chain
Management
Bedsiz e: 309

Freeman Health System

Booth # 209
Joplin, MO
Jeffery Thompson, *PharmD*
Director of Pharmacy Services
Bedsiz e: 389

Garden Grove Hospital & Medical Center

Booth # 1306
Garden Grove, CA
Binh Mac
Pharmacy Director
Bedsiz e: 167

Geisinger Health System

Booth # 704
Danville, PA
John Jones, *RPh*
Vice President
Bedsiz e: 1139
Outpatient Pharmacy: Yes

Geisinger-Lewistown Hospital

Booth # 705
Lewistown, PA
Richard Stomackin, *BS Pharm, R.Ph.*
Director of Pharmacy
Bedsiz e: 123
Outpatient Pharmacy: Yes

George Washington University Hospital

Booth # 415
Washington, DC
Renia Mathews, *PharmD*
Director of Pharmacy
Bedsiz e: 370

Good Samaritan Hospital (CHI)

Booth # 204
Kearney, NE
Nicki Bohl, *PharmD*
Director of Pharmacy
Bedsiz e: 286

Good Shepherd Medical Center

Booth # 1706
Longview, TX
Brad Osburg, *RPh*
Director of Pharmacy
Bedsiz e: 425
Outpatient Pharmacy: Yes

Good Shepherd Rehabilitation Hospital

Booth # 810
Allentown, PA
Robert Shuminski, *RPh, MBA*
Director of Pharmacy
Bedsiz e: 263

Gundersen Health

Booth # 403
LaCrosse, WI
Michael Meyers, *PharmD*
Administrative Director of Pharmacy
Bedsiz e: 325
Outpatient Pharmacy: Yes

Harlingen Medical Center

Booth # 1718
Harlingen, TX
Mitchell Everett, *RPh*
Director of Pharmacy
Bedsiz e: 112

Hartford Healthcare

Booth # 1503
New Britain, CT
David Girouard
Central Region Director of Pharmacy
Bedsiz e: 414

What's Under Your Hood?



IMI offers a complete range of products designed specifically for the sterile compounding pharmacist including our renowned line of Prep-Lock™ tamper evident caps for luer lock syringes.

Prep-Lock™

Tamper Evident Syringe Caps

RX-Vent™

Filtered Venting Needles

Prep-Seal™

Caps and Plugs

RX-Tract™

Aspirating Needles

Prep-Fill™

Luer Lock and Slip Connectors

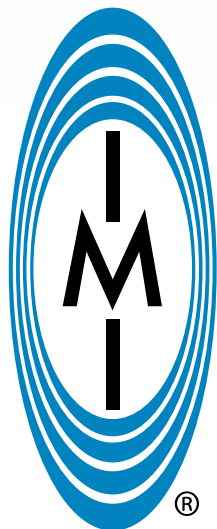
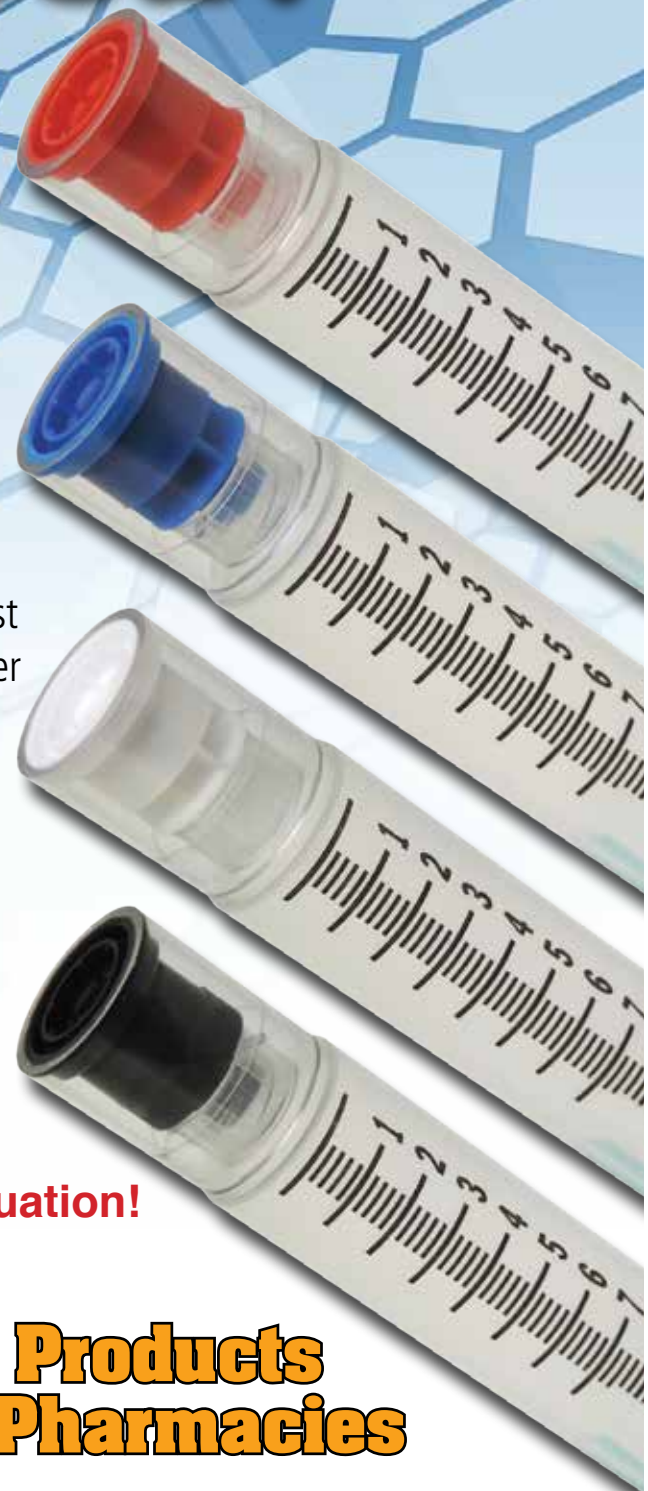

FREE Sterile Samples for Evaluation!

**Innovative Sterile Products
for Compounding Pharmacies**

800-344-2554

www.imiweb.com

International Medical Industries, Inc.



PROVIDER ATTENDEES LIST BY FACILITY



HCA Healthcare

Booth # 715
Nashville, TN
Nicole Bryan, *PharmD, MBA*
Director, Performance Improvement-
Pharmacy
Bedsizes: 18000

HealthAlliance of Hudson Valley

Booth # 603
Kingston, NY
Priti Shah, *RPh*
Director of Pharmacy Services
Bedsizes: 315

Health-First

Booth # 907
Melbourne, FL
Jay Pauly, *PharmD*
Clinical Pharmacy Manager
Bedsizes: 1000

HealthTrust-HCA

Booth # 714
Brentwood, TN
James Eldridge, *PharmD, MBA*
Director, Pharmacy Utilization and Operations
Bedsizes: 1647

Hillcrest Medical Center

Booth # 1811
Tulsa, OK
Bradley Atherton, *D.Ph*
Director of Pharmacy Services
Bedsizes: 729
Outpatient Pharmacy: Yes

Hoag Orthopedic Institute

Booth # 1405
Irvine, CA
Kim Dinh
Pharmacy Manager

Hospital for Special Surgery

Booth # 601
New York, NY
Tina Yip
Chief Pharmacy Officer
Bedsizes: 205

Houston Medical Center

Booth # 913
Warner Robins, GA
Tiena Fletcher, *RPh, MSA, MBA*
Director of Pharmacy
Bedsizes: 250
Outpatient Pharmacy: Yes

Huntsville Hospital

Booth # 1008
Huntsville, AL
Michael McDaniel, *RPh, MBA, FASHP*
Director of Pharmacy
Bedsizes: 881
Outpatient Pharmacy: Yes

Huntsville Hospital for Women and Children

Booth # 1007
Huntsville, AL
Susan Robbins, *RPh*
Pharmacy Manager
Bedsizes: 200
Outpatient Pharmacy: Yes

James Cancer Hospital at OSU

Booth # 1502
Columbus, OH
Julie Kennerly, *PharmD, MS, BCPS*
Assistant Director, Specialty Pharmacy
Services
Bedsizes: 971
Outpatient Pharmacy: Yes

James Cancer Hospital at OSU

Booth # 1501
Columbus, OH
Niesha Griffith, *MS, RPh, FASHP*
Administrator, Oncology Pharmacy & Infusion
Svcs
Bedsizes: 971

Jefferson Regional Medical Center

Booth # 1111
Pine Bluff, AR
Lelan Stice, *PD, MBA*
Administrative Director of Pharmacy
Bedsizes: 471
Outpatient Pharmacy: Yes

Kern Medical Center

Booth # 1406
Bakersfield, CA
Dawn Lorenzo, *PharmD*
Pharmacy Director
Bedsizes: 222
Outpatient Pharmacy: Yes

Kingwood Medical Center (HCA)

Booth # 1610
Kingwood, TX
David Chuang, *PharmD*
Pharmacy Director
Bedsizes: 256

Lake Regional Health System

Booth # 211
Osage Beach, MO
Tom Myler
Director of Pharmacy
Bedsizes: 118

Lake Wales Medical Center

Booth # 911
Lake Wales, FL
Kennetha Colorado-Tiner, *PharmD*
Director, Pharmacy Services
Bedsizes: 160

Lawrence & Memorial Hospital Systems

Booth # 1504
New London, CT
Warren Rogers, *RPh*
Director of Pharmacy Services
Bedsizes: 300
Outpatient Pharmacy: Yes

Lehigh Valley Health Network

Booth # 706
Allentown, PA
Robert Begliomini, *PharmD, MBA*
Administrator, Pharmacy Services
Bedsizes: 950

Lehigh Valley Hospital-Hazleton

Booth # 707
Hazleton, PA
Ray Bernardi, *PharmD*
Director of Pharmacy
Bedsizes: 160

LewisGale Medical Center

Booth # 1507
Salem, VA
Anita Atkins, *RPh, MBA*
Director of Pharmacy Services
Bedsizes: 290

Long Island College Hospital

Booth # 602
Brooklyn, NY
Joseph Abinanti, *MS, RPh*
Director of Pharmacy Services
Bedsizes: 400
Outpatient Pharmacy: Yes

Lourdes Health System

Booth # 511
Camden, NJ
William Haigh
Assistant Director
Bedsizes: 380

Martin Health System- South Hosp

Booth # 904
Stuart, FL
Judy Del Toro, *PharmD*
Pharmacy Manager
Bedsizes: 344

Martin Health Systems

Booth # 903
Stuart, FL
David Harlow
Chief Pharmacy Officer
Bedsizes: 450

PROVIDER ATTENDEES LIST BY FACILITY



Martin Medical Center

Booth # 901
Stuart, FL
Ivette Ramus, *RPh*
Pharmacy Operations Manager
Bedsiz e: 244

Massachusetts General Hospital

Booth # 507
Boston, MA
Alexander Weatherall, *MBA*
Administrative Director of Pharmacy
Bedsiz e: 950
Outpatient Pharmacy: Yes

Massachusetts General Hospital

Booth # 506
Boston, MA
Michael Urbati
Pharmacy Inventory Integrity Manager
Bedsiz e: 950
Outpatient Pharmacy: Yes

Maury Regional Medical Center

Booth # 1114
Columbia, TN
Jefferson Binkley, *PharmD, BCNSP, FASHP*
Director of Pharmacy
Bedsiz e: 258
Outpatient Pharmacy: Yes

McLane Children's Hospital (Baylor S&W)

Booth # 1707
Temple, TX
Chanin Wright, *PharmD*
Director of Pharmacy
Bedsiz e: 112
Outpatient Pharmacy: Yes

McLaren-Central Michigan

Booth # 409
Mt. Pleasant, MI
James Baxter, *RPh*
Director of Pharmacy
Bedsiz e: 118

McLeod Health

Booth # 1210
Florence, SC
Charles Rozak, *MS*
Pharmacy Director
Bedsiz e: 480
Outpatient Pharmacy: Yes

McLeod Regional Medical Center

Booth # 1211
Florence, SC
Artie McKnight, *RPh*
Pharmacy Business Manager
Bedsiz e: 505

MedAssets

Booth # 1807
Plano, TX
Jimmy Loftin, *RPh*
Vice President, Pharmacy

MedAssets

Booth # 1808
Plano, TX
Ron Hartmann, *PharmD*
Senior VP, Pharmacy

MedAssets

Booth # 1809
Leander, TX
Sam Colletti, *RPh*
Director, Clinical Pharmacy - CHRISTUS Health

MedAssets HSCA (Ascension Health)

Booth # 102
St. Louis, MO
Ginger Ertel, *PharmD*
Director, Clinical Pharmacy Services
Bedsiz e: 450

Medical Center Arlington

Booth # 1704
Arlington, TX
Darrell Newcomer, *MS, FASHP*
Director of Pharmacy
Bedsiz e: 336

Medical Center of Lewisville

Booth # 1815
Lewisville, TX
Tammi Hayes
Ops Manager, Pharmacy
Bedsiz e: 202
Outpatient Pharmacy: Yes

Medical University of South Carolina

Booth # 1214
Charleston, SC
Donna Barrio, *PharmD*
Coordinator, Pharmacy Support Services
Bedsiz e: 720

Memorial Hermann Healthcare System

Booth # 1708
Houston, TX
Angela Ward
System Executive - Pharmacy
Bedsiz e: 3372
Outpatient Pharmacy: Yes

Memorial Hospital Chattanooga

Booth # 1202
Chattanooga, TN
Rodney Elliott
Pharmacy P.A./Technology Coordinator
Bedsiz e: 405
Outpatient Pharmacy: Yes

Memorial Hospital of Salem County

Booth # 513
Salem, NJ
Tracie Chambers, *RPh*
Director of Pharmacy
Bedsiz e: 140

Memorial Sloan Kettering Cancer Center

Booth # 607
New York, NY
Stella Eng, *RPh*
Associate Director
Bedsiz e: 514
Outpatient Pharmacy: Yes

Mercy El Reno, Kingfisher & Watonga Hospitals

Booth # 308
Kingfisher, OK
Marette Forman, *DPH*
Mercy Rural Pharmacy Services Manager
Bedsiz e: 98

Mercy Fitzgerald Hospital

Booth # 610
Darby, PA
Stephen Critz
Director of Pharmacy
Bedsiz e: 211
Outpatient Pharmacy: Yes

Mercy General Hospital (Dignity Health)

Booth # 1601
Sacramento, CA
Jeffrey Nehira
Director of Pharmacy
Bedsiz e: 342

Mercy Health

Booth # 306
Chesterfield, MO
Jonathan Lakamp, *PharmD, BCPS*
Vice President, Pharmacy
Bedsiz e: 4438
Outpatient Pharmacy: Yes

Mercy Hospital Fort Scott

Booth # 309
Fort Scott, KS
Craig Campbell, *RPh*
Director of Pharmacy
Bedsiz e: 127
Outpatient Pharmacy: Yes

Mercy Hospital Oklahoma City

Booth # 307
Oklahoma City, OK
Keith Madison, *PharmD*
Regional Executive Director of Pharmacy
Bedsiz e: 400
Outpatient Pharmacy: Yes



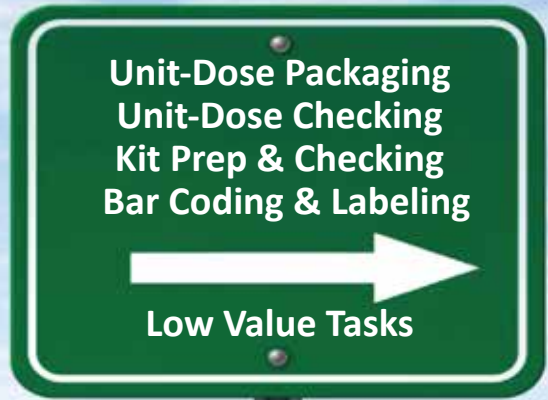

Which path do you want your pharmacy staff to follow?

- Do you want your pharmacists and technicians to devote more time in certain high value areas?
- If they had more time, could your staff make a bigger impact on reducing drug costs and improving patient care?
- Are your pharmacists and technicians spending too much time on unit-dose packaging and bar coding?

Let Safecor Health help you save on drug packaging costs, reduce packaging errors and improve your staff utilization.

Available Repackaging Formats

- Oral Solids
- Oral Liquid Cups
- Oral Syringes
- Standardized Pediatric Doses
- Rx RFID Tagging Services
- Robot Packaging
- Respiratory Medication Bar Coding
- Schedule II-V Repackaging

Repackaging Program Highlights

- Place orders through your wholesaler
- Service Awards with all major GPO's
- Multi-site and multi-state health system capabilities
- Services billed through your wholesaler
- All bar code types and customized bar code content available



PROVIDER ATTENDEES LIST BY FACILITY



Mercy Hospital Springfield
Booth # 305
Springfield, MO
Shane Edmonson
Director of Acute Care Pharmacy
Bedsizes: 886

Mercy Medical Center Clinton
Booth # 615
Clinton, IA
Ifedapo Sonuga, *PharmD*
Director of Pharmacy
Bedsizes: 351

Mercy Medical Center of Redding
Booth # 1602
Redding, CA
John Choi
Director of Pharmacy
Bedsizes: 273

Mercy Philadelphia Hospital
Booth # 609
Philadelphia, PA
Joy Cho
Director of Pharmacy
Bedsizes: 178

Methodist Charlton Medical Center
Booth # 1702
Dallas, TX
Jeena Connor
Director of Pharmacy Services
Bedsizes: 309

Methodist Dallas Medical Center
Booth # 1703
Dallas, TX
Jon Albrecht, *RPh, MHA, BCNSP, FASHP*
Director of Pharmacy
Bedsizes: 515

Methodist Jennie Edmundson Hospital
Booth # 108
Council Bluffs, IA
Melanie Ryan, *PharmD*
Clinical Manager
Bedsizes: 110

Mid-America Division HCA, Parallon
Booth # 202
Shawnee, KS
Joseph Burwinkle, *BS, MS*
Division Director of Pharmacy Operations
Bedsizes: 1398

Mission Health System
Booth # 1205
Asheville, NC
Doug DeJong, *RPh, MBA, FASHP*
Executive Director of Pharmacy
Bedsizes: 810
Outpatient Pharmacy: Yes

Mission Health System
Booth # 1206
Asheville, NC
Tim Gentilcore, *PharmD*
Director of Outpatient Pharmacy
Bedsizes: 1000
Outpatient Pharmacy: Yes

Mobile Infirmary Medical Center
Booth # 1013
Mobile, AL
Michelle Wheat
Pharmacy Manager
Bedsizes: 704
Outpatient Pharmacy: Yes

Mother Frances Hospital
Booth # 1711
Tyler, TX
J. McCoy, *PharmD*
Director of Pharmacy
Bedsizes: 468
Outpatient Pharmacy: Yes

Mt. Auburn Hospital
Booth # 502
Cambridge, MA
Greg Sophis, *MBA, RPh*
Director of Pharmacy Services
Bedsizes: 217

Nacogdoches Memorial Hospital
Booth # 1816
Nacogdoches, TX
David Schaefer, *MS, RPh*
Director of Pharmacy
Bedsizes: 206
Outpatient Pharmacy: Yes

Nassau University Medical Center
Booth # 515
East Meadow, NY
Marcelle Levy-Santoro, *MS, RPh, FNAPH*
Administrator of Pharmacy Services
Bedsizes: 450

National Park Medical Center
Booth # 1109
Hot Springs, AR
Bill Reeves, *PD, RPh, MBA*
Director of Pharmacy/Respiratory/Cardio-
Neuro
Bedsizes: 166

New York City Health & Hospital Corporation
Booth # 605
New York, NY
Vincent Giambanco, *RPh, MS*
Director, Procurement and Operations
Bedsizes: 8338
Outpatient Pharmacy: Yes

North Mississippi Medical Center
Booth # 1102
Tupelo, MS
Donna Huggins, *RPh*
Assistant Director of Pharmacy
Bedsizes: 650

North Mississippi Medical Center
Booth # 1101
Tupelo, MS
Patti Hawkins, *PharmD*
Director-Outpatient Services
Bedsizes: 650
Outpatient Pharmacy: Yes

Northeast Baptist Hospital (Baptist Hlth Sys)
Booth # 1701
San Antonio, TX
Lois Taylor
Director of Pharmacy
Bedsizes: 275

Northeast Georgia Health System
Booth # 1004
Gainesville, GA
Melissa Frank, *Pharm.D.*
Assistant Director of Pharmacy
Bedsizes: 567
Outpatient Pharmacy: Yes

Northeast Georgia Health System (NGHS)
Booth # 1003
Gainesville, GA
Stephen Carlson, *RPh, MHA*
Director of Pharmacy
Bedsizes: 557
Outpatient Pharmacy: Yes

Northern Arizona Health
Booth # 1607
Flagstaff, AZ
Richard Mendribil, *Pharm.D.*
Health System Director of Pharmacy
Bedsizes: 400
Outpatient Pharmacy: Yes

Northridge Hospital Med Ctr
Booth # 1603
Northridge, CA
Blair Galbreath, *PharmD*
Director of Pharmacy
Bedsizes: 411

Norwalk Hospital
Booth # 1505
Norwalk, CT
Robert Bepko, Jr., *R.Ph., M.H.A.*
Director of Professional Services
Bedsizes: 328
Outpatient Pharmacy: Yes



PROVIDER ATTENDEES LIST BY FACILITY



Novation
Booth # 1713
Irving, TX
Sara Bongfeldt
Portfolio Executive

Novation
Booth # 1712
Irving, TX
Leslie Larsen
Portfolio Executive

NYU Langone Medical Center
Booth # 514
New York, NY
Arash Dabestani, *PharmD, MHA, FASHP, FABC*
Senior Director of Pharmacy
Bedsizes: 1000
Outpatient Pharmacy: Yes

Oak Hill Hospital
Booth # 814
Brooksville, FL
Michael Jackson, *Pharm.D*
Director of Pharmacy
Bedsizes: 262

Oakwood Hospital and Medical Center
Booth # 406
Dearborn, MI
David Batkie, *RPh, MBA*
Director of Pharmacy
Bedsizes: 600
Outpatient Pharmacy: Yes

Ocala Reg Med Ctr & West Marion Com Hosp
Booth # 815
Ocala, FL
Jerry Cummings
Director of Pharmacy
Bedsizes: 270

Oklahoma Heart Hospital-North Campus
Booth # 1810
Oklahoma City, OK
Susan Beacham
Director
Bedsizes: 99

Olympia Medical Center
Booth # 1308
Los Angeles, CA
Annette Marquez
Director of Pharmacy
Bedsizes: 204

Onslow Regional Medical Center
Booth # 1203
Jacksonville, NC
Vincent Lee, *PharmD*
Director of Pharmacy & Oncology
Bedsizes: 162

Orlando Health
Booth # 703
Orlando, FL
Frank Thomas, *RPh, CPh, MBA*
Corporate Pharmacy Contracts Coordinator
Bedsizes: 2000

Oroville Hospital
Booth # 1304
Oroville, CA
Daniel Nguyen
Director of Pharmacy
Bedsizes: 153

OSF St. Francis Medical Center
Booth # 312
Peoria, IL
Jerry Storm, *R.Ph.*
Director of Pharmacy
Bedsizes: 616
Outpatient Pharmacy: Yes

Ottumwa Regional Health Center
Booth # 107
Ottumwa, IA
Thomas Henry, III
Director of Pharmacy
Bedsizes: 217

Our Lady of Lourdes Regional Medical Center
Booth # 1106
Lafayette, LA
Edward Broussard, *RPH, MBA*
Director of Pharmacy
Bedsizes: 186

Our Lady of the Lake Regional Medical Center
Booth # 1105
Baton Rouge, LA
Michael Mohundro, *Pharm.D.*
Director of Pharmacy
Bedsizes: 756
Outpatient Pharmacy: Yes

Owensboro Health Regional Hospital
Booth # 1513
Owensboro, KY
Heather Haynes
Director of Pharmacy
Bedsizes: 484
Outpatient Pharmacy: Yes

Parallon/HCA North Florida Division
Booth # 910
Jacksonville, FL
Michael Deschaine
Division Director of Pharmacy Operations
Bedsizes: 2000

PDM Healthcare
Booth # 315
Cleveland, OH
Ash Chawla
President/CEO

PDM Healthcare
Booth # 315
Cleveland, OH
Kimberly Arth

PDM Healthcare
Booth # 315
Cleveland, OH
Tony Viridi
Director, Contracts & Sales Administration

Phelps County Regional Medical Center
Booth # 206
Rolla, MO
Kreig Moore, *RPh*
Director of Pharmacy Services
Bedsizes: 242
Outpatient Pharmacy: Yes

Premier Inc.
Booth # 1312
Charlotte, NC
Angela Merryman, *RPh, MS*
Director, Pharmacy Contracting

Premier Inc.
Booth # 1311
Charlotte, NC
Chris Jones, *R.Ph*
Director- Pharmacy Automation

Premier Inc.
Booth # 1315
Lisle, IL
Karen Bertch, *PharmD, FCCP*
Director, Pharmacy Drug Intelligence

Premier Inc. (Catholic Contracting Group)
Booth # 1314
Charlotte, NC
Michael Maguire
VP- Member Field Services
Bedsizes: 5000

Premier, Inc.
Booth # 1313
Charlotte, NC
Wayne Russell, *RPh, Pharm.D.*
Senior Director

Presbyterian Hospital of Denton
Booth # 1717
Denton, TX
Brad Dickinson, *PharmD*
Assistant Director of Pharmacy
Bedsizes: 250

Unit Dose Done Right

Unit Dose,
Bar Coding,
Pharmacy &
Nursing Supply
Experts!



- Ultraviolet Inhibitant
- Moisture Resistant
- Tamper-Evident
- Cold Seal
- 6 and 12-month Beyond-Use Dating
- 1-D and 2-D Bar Coding
- Flexible Label and Report Formatting
- Multiple Sizes to Fit Your Meds and Storage Needs

Simple. Reliable. Medi-Dose®

800.523.8966

MediDose.com

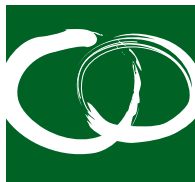

HEALTH CONNECT PARTNERS

HOSPITAL PHARMACY

CONFERENCE | FALL 14

October 6 - 8

Chicago, IL

REGISTER TODAY!

\$1,595/each

VISIT OUR REGISTRATION OR SALES DESK TO REGISTER AT THIS SPECIAL RATE
UNTIL NOON WEDNESDAY, 5/7/14. AFTER THE CONFERENCE THE PRICE INCREASES TO \$1,795

PROVIDER ATTENDEES LIST BY FACILITY



Presence Saint Joseph Medical Center

Booth # 311
Joliet, IL
Mark Deaton
Pharmacy Operations Manager
Bedsizes: 483

Promise Healthcare

Booth # 906
Boca Raton, FL
Nish Patel, *PharmD*
VP, Corporate Pharmacy Operations
Bedsizes: 950

Providence Health & Services Corporate

Booth # 1301
Renton, WA
Scott Jamieson, *RPh, MBA*
System Director, Pharmacy Services
Bedsizes: 6500
Outpatient Pharmacy: Yes

Providence Hospital - Mobile

Booth # 1010
Mobile, AL
Gino Agnelly
Director of Pharmacy
Bedsizes: 349

Rapid City Regional Hospital

Booth # 103
Rapid City, SD
Dana Darger, *RPh*
Director of Pharmacy
Bedsizes: 417
Outpatient Pharmacy: Yes

Research Medical Center

Booth # 208
Kansas City, MO
Robert Bub, *PharmD*
Director of Pharmacy
Bedsizes: 545

Resource Optimization & Innovation (ROi)

Booth # 302
Chesterfield, MO
Jennifer Lee-Moss, *PharmD*
Director - Pharmacy, Clinical Services
Bedsizes: 4098

Roger Williams Medical Center

Booth # 712
Providence, RI
James Melfi, *RPh, PharmD, PhD*
Director of Pharmacy
Bedsizes: 220
Outpatient Pharmacy: Yes

ROi

Booth # 304
St. Louis, MO
Angela Lochmann
Contract Manager, Pharmacy
Bedsizes: 4673

ROi

Booth # 303
St. Louis, MO
Jill Webb
Senior Contract Manager - Pharmacy
Bedsizes: 7555

ROi

Booth # 301
St. Louis, MO
John Kleiss, *PharmD*
Executive Director
Bedsizes: 4438

Sacred Heart Hospital

Booth # 808
Pensacola, FL
Tara Smith
Clinical Pharmacy Manager
Bedsizes: 455
Outpatient Pharmacy: Yes

Saint Agnes Hospital

Booth # 412
Baltimore, MD
Greg Smith, *RPh, MBA*
Director of Pharmacy
Bedsizes: 315

Saint Francis Health System

Booth # 1812
Tulsa, OK
Ron Kolar, *DPh, MS, FASHP*
System Director of Pharmacy Services
Bedsizes: 970

Saint Francis Medical Center

Booth # 608
Trenton, NJ
Joseph Latini
Director of Pharmacy
Bedsizes: 235

Saint Francis Medical Center

Booth # 1108
Monroe, LA
Mike Hymel, *RPh*
Director of Pharmacy
Bedsizes: 550

San Mateo Medical Center

Booth # 1403
San Mateo, CA
Gary Horne, *R.Ph., MSHA*
Director of Pharmacy
Bedsizes: 509
Outpatient Pharmacy: Yes

SBH Health System

Booth # 604
Bronx, NY
Ruth Cassidy, *B.S. PharmD*
Vice President
Bedsizes: 660

Scotland Health Care System

Booth # 1208
Laurinburg, NC
Paul Chu
Director of Pharmacy
Bedsizes: 172

Sentara Healthcare

Booth # 1512
Norfolk, VA
Edwin Gutshall, *PharmD*
Pharmacy Business Manager
Bedsizes: 2000

Shannon Medical Center

Booth # 1814
San Angelo, TX
Steve Lubke, *R.Ph.*
Pharmacy Director
Bedsizes: 411

Sharon Regional Health System

Booth # 709
Sharon, PA
Michael Dick
Director of Pharmacy
Bedsizes: 251

Sierra View District Hospital

Booth # 1408
Porterville, CA
Aaron Gates
DOP
Bedsizes: 167

Southern Illinois Healthcare

Booth # 313
Carbondale, IL
Robert Self
System Director of Pharmacy
Bedsizes: 927

Southwestern Medical Center

Booth # 1813
Lawton, OK
Robin Garmon
Director of Pharmacy
Bedsizes: 199

PROVIDER ATTENDEES LIST BY FACILITY



Spartanburg Regional Healthcare System Booth # 1215

Spartanburg, SC
George Reid, *PharmD*
System Director of Pharmacy Services
Bedsizes: 760
Outpatient Pharmacy: Yes

St Lukes Hospital at The Vintage Booth # 1710

Houston, TX
Jerry King, *RPh, MBA*
Director of Pharmacy
Bedsizes: 94

St. Anthony's Health Center Booth # 214

Alton, IL
Mary Wendle, *RPh*
Director of Pharmacy
Bedsizes: 199

St. Christopher's Hospital for Children Booth # 710

Philadelphia, PA
Loan Vu, *PharmD, MBA*
Director of Pharmacy Services
Bedsizes: 186

St. Dominic Hospital Booth # 1014

Jackson, MS
Mary Helen Bowen
Assistant VP, Pharmacy Services
Bedsizes: 536
Outpatient Pharmacy: Yes

St. Elizabeth Hospital Booth # 1107

Gonzales, LA
Tammy Belleau, *RPh*
Director of Pharmacy
Bedsizes: 78

St. Francis Hospital Booth # 614

Wilmington, DE
Cheri Briggs, *B.Pharm, PharmD, MBA*
Director of Pharmacy
Bedsizes: 365

St. Francis Hospital, Inc. Booth # 914

Columbus, GA
John Drew, III, *PharmD*
DOP
Bedsizes: 376

St. Francis Medical Center Booth # 1402

Lynwood, CA
Gerald Boden, *PharmD*
Sr Director, Professional Services
Bedsizes: 384

St. John Hospital & Medical Ctr (Ascension) Booth # 408

Detroit, MI
Kevin Dubay
Mgr, Operations Department of Pharmacy Svcs
Bedsizes: 800

St. Joseph Healthcare Booth # 414

Bangor, ME
Mark Miller, *PharmD*
Director of Pharmacy Services
Bedsizes: 114
Outpatient Pharmacy: Yes

St. Mary's Health Care System Booth # 912

Athens, GA
Gary Wright, *RPh*
Pharmacy Director
Bedsizes: 196

St. Rose Dominican Hospital San Martin Campus

Las Vegas, NV
Reed Howe, *PharmD*
Pharmacy Director
Bedsizes: 266

St. Rose Dominican Hospitals Booth # 1605

Henderson, NV
Jason Glick
Director of Pharmacy
Bedsizes: 266

St. Vincent Carmel Hospital Booth # 100

Carmel, IN
Michael Mendenhall
Pharmacy Director
Bedsizes: 124

St. Vincent Indianapolis Hospital Booth # 101

Indianapolis, IN
Anthony Antonopoulos
Executive Director, Regional Pharmacy
Services
Bedsizes: 1200

Stanford Hospital & Clinics Booth # 1407

Stanford, CA
Deepak Sisodiya, *PharmD, MHA, BCPS*
Director, Department of Pharmacy
Bedsizes: 631
Outpatient Pharmacy: Yes

Steward Health Care System Booth # 505

Boston, MA
Pam Mimms-Cox
Corporate Pharmacy Director
Bedsizes: 2096

Sutter Roseville Medical Center Booth # 1400

Roseville, CA
Kathleen Black, *Pharm.D.*
Supervisor, Inpatient Pharmacy
Bedsizes: 328

Swedish American Hospital Booth # 310

Rockford, IL
Thomas Carey, *PharmD*
Director of Pharmacy Services
Bedsizes: 355
Outpatient Pharmacy: Yes

Texas Health Huguley (Adventist Health) Booth # 807

Burleson, TX
James Hall, *RPH*
Director of Pharmacy
Bedsizes: 223

Texas Health Presbyterian Hospital Booth # 1709

Flower Mound, TX
Todd Connor
Director of Pharmacy
Bedsizes: 103

Trinity Health Booth # 612

Livonia, MI
Bob Ripley
Director of Pharmacy Operations
Bedsizes: 10916
Outpatient Pharmacy: Yes

Trinity Health System Booth # 401

Steubenville, OH
Gerald John, *RPh, MS*
Director of Pharmacy
Bedsizes: 519
Outpatient Pharmacy: Yes

Supplying the industry with the most important pharmacy tool:

People.

We don't just fill your positions. We fulfill your needs.

At Soliant, people are our business. We treat our pharmacy talent and you, our customer, in the same manner as you treat your customers and patients: with respect and special care.

Call us and experience the Soliant difference for all of your pharmacy staffing needs:

- Per diem / part-time / full-time
- Travel
- Permanent placement
- Interim director / management positions

No matter what position you need to fill, there's one name for it. Soliant Health.

With divisions focusing in pharmacy, physician search, travel nursing, imaging, rehabilitation, respiratory therapy, and laboratory, we have the ability to fill any position within your facility.

Sound different? We are.

Call us today at 877-340-0521 or visit us at www.soliant.com to find out more.



PROVIDER ATTENDEES LIST BY FACILITY



Union Hospital of Cecil County

Booth # 413
Elkton, MD
David Jaspan, *BS, Pharm, MBA*
Director, Pharmacy and Materials
Management
Bedsizes: 125

United Regional Health Care System

Booth # 1705
Wichita Falls, TX
Matt Baker, *PharmD, BCPS*
Director of Pharmacy
Bedsizes: 350

University Hospital

Booth # 915
Augusta, GA
Marie Jackson
Director of Pharmacy
Bedsizes: 550

University of Mississippi Medical Center

Booth # 1103
Jackson, MS
Michael Todaro, *PharmD*
Director of Pharmacy
Bedsizes: 722
Outpatient Pharmacy: Yes

University of Pennsylvania Health System

Booth # 812
Philadelphia, PA
Nishaminy Kasbekar, *BS, PharmD, FASHP*
Corporate Director of Pharmacy
Bedsizes: 450
Outpatient Pharmacy: Yes

UPMC - Altoona

Booth # 811
Altoona, PA
Neal Maneval, *BS, RPh*
Director of Pharmacy
Bedsizes: 350

Via Christi Health

Booth # 203
Pittsburg, KS
Lotanna Okeke, *RPh, MBA, CDE*
Director of Pharmacy
Bedsizes: 125
Outpatient Pharmacy: Yes

Virginia Hospital Center

Booth # 1508
Reston, VA
Dana Anderson
Director of Pharmacy
Bedsizes: 334

Vista Medical Center East

Booth # 213
Waukegan, IL
Kathryn Jost, *PharmD*
Director of Pharmacy
Bedsizes: 260

Waukesha Memorial Hospital

Booth # 402
Waukesha, WI
Virginia Mendoza, *BS Pharmacy*
Operations Manager
Bedsizes: 285
Outpatient Pharmacy: Yes

Westerly Hospital

Booth # 713
Westerly, RI
Brian Musiak, *PharmD, MBA*
Director of Pharmacy
Bedsizes: 125
Outpatient Pharmacy: Yes

Western Medical Center - Anaheim

Booth # 1302
Anaheim, CA
Lesley Wolder
Pharmacy Director
Bedsizes: 188

Wheaton Franciscan Health System

Booth # 405
Glendale, WI
Christopher Dykstra
Pharmacy Operations Manager
Bedsizes: 1390
Outpatient Pharmacy: Yes

Wheaton Franciscan Inc.

Booth # 404
Milwaukee, WI
Lijian Cai
Administrative Director of Pharmacy Services
Bedsizes: 764

Windsor Regional Hospital

Booth # 112
Windsor, Ontario
John Payne
Pharmacy Business Manager
Bedsizes: 700

Wyoming Medical Center

Booth # 1606
Casper, WY
Michael Magee
DOP
Bedsizes: 211

Yavapai Regional Medical Center

Booth # 1609
Prescott, AZ
Jeff Anderson, *Pharm.D., M.S., BCPS*
Director of Pharmacy Services
Bedsizes: 206

THANKS TO OUR SPONSORS



CardinalHealth

Essential to care™



For information on future sponsorship opportunities, please visit Jason Green at the HCP booth in the expo hall.



Do **more** with less.

Cardinal Health Drug Cost Control Solution

As you are forced to do a lot with a little, you want to make sure you use the right tool for the job. The Cardinal Health Drug Cost Control Solution achieves cost savings for hospitals and can significantly improve patient outcomes and decrease lengths of stay. Through the use of analytics to benchmark drug utilization by physician and DRG, we help hospitals implement and achieve savings of three-to-five percent — or more — on annual pharmaceutical expenses.

1.877.300.9180

cardinalhealth.com/innovativedeliverysolutions

Call today to learn how to do more with less.

